

Barre aluminium
Aluminium bar
20x20

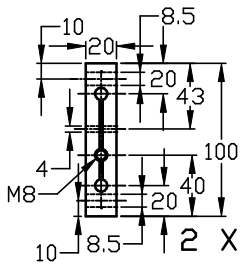

Tubes acier 20 x 20
tous les trous sont en
diam 8.5, sauf indication
contraire

Steel tubes 20x20
all holes are diam
8.5, except where
indicated

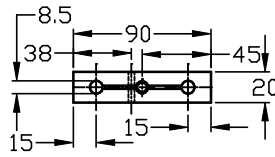
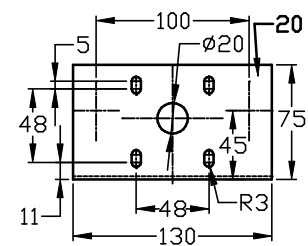
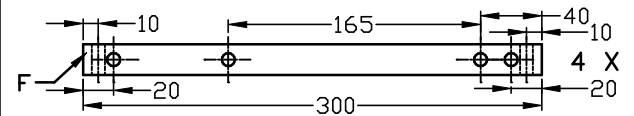
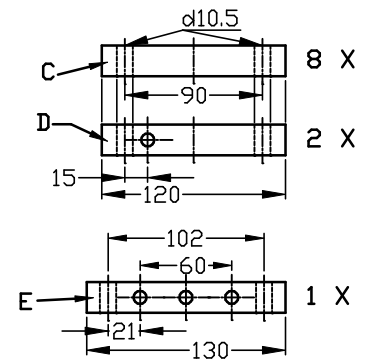
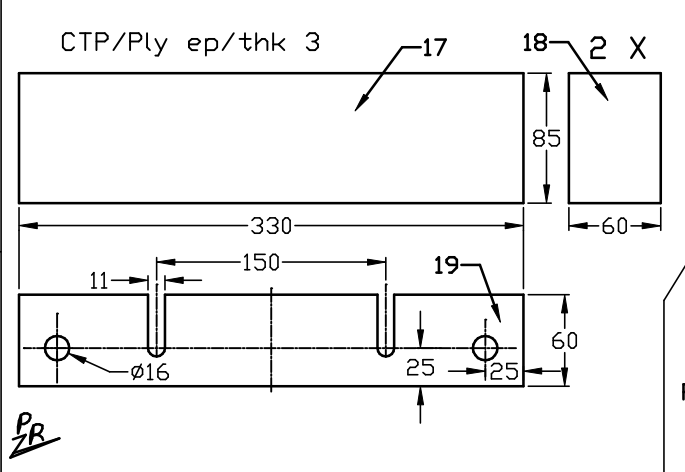
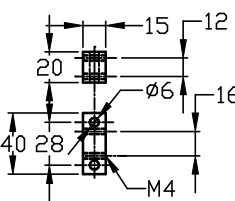
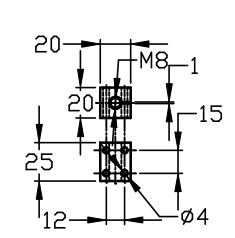
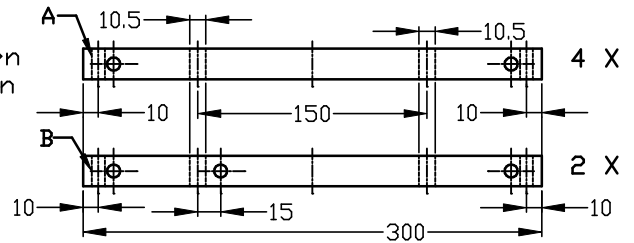

Version 1 seul moteur sur l'axe X
Version one stepper on X axis

Cornière acier ep. 1.5/2 mm
(fixation charpente)
Steel angle thk 1.5/2 mm
(wood fixture)

CTP/Ply ep/thk 16
Plaques dessinées
pour un moteur taille
NEMA 23: 57x57
Plates designed for
NEMA 23 stepper size

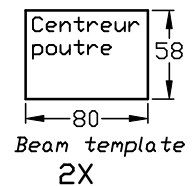
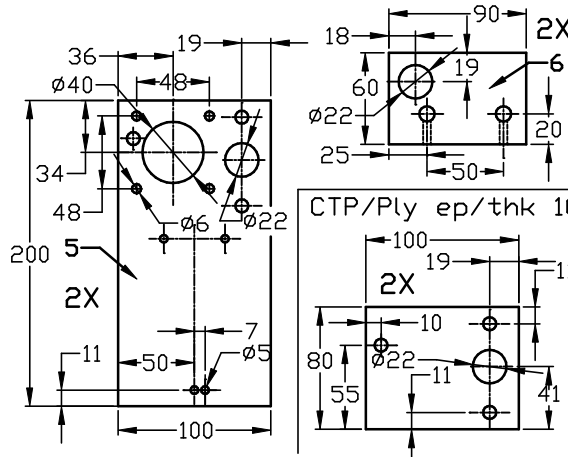
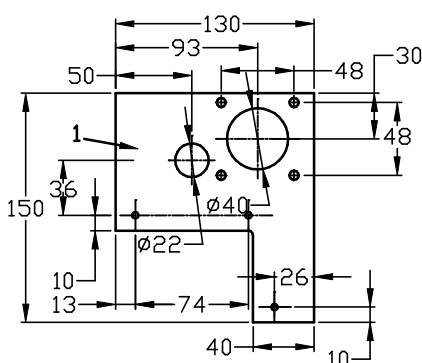
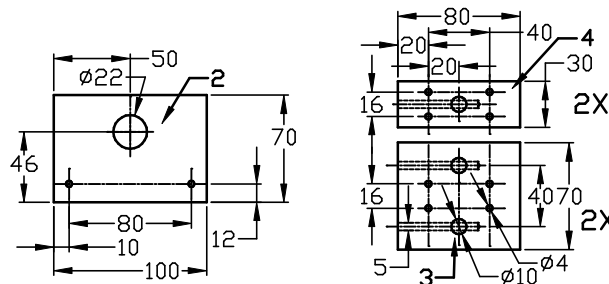

www.cncloisirs.com
www.otocoup.com

Reusable under the conditions defined by the Creative Common Licence: Attribution, Non-commercial, Share alike
Réutilisable sous les conditions définies par la licence Creative Common : Paternité ,
Non-commercial , Partage à l'identique cc: by-nc-sa

(c) Pierre ROUZEAU 2003-2004. Machine '3Dcoup'. Diffusion 'tel que', à titre gracieux pour une utilisation
personnelle uniquement. L'auteur ne peut être tenu pour responsable de quoi que ce soit. Non testé.
'3Dcoup' machine, supplied freely 'as is' for personal use only. Author cannot be liable for anything. Untested

rev.4
sh. 6/9